

EN



**ATTENTION:**

Read this user manual carefully before you use the appliance and save it for future reference.



**ATTENTION:**

When using electrical appliance, basic safety precautions should always be followed to reduce the risk of fire, electrical shock and personal injury.

**I. SAFETY INFORMATION:**

1. Incorrect operation and improper handling can lead to faults on the device and injuries to the user.
2. In the event of improper use or incorrect handling, no liability can be accepted for any damage that may occur.
3. Before you put the plug into the socket, please check that the type of current and mains voltage correspond to the instructions on the name plate on the underside of the appliance.
4. Do not immerse the unit or mains plug in water or other liquids. There is a risk of electric shock! However, if this should occur, remove the mains plug immediately and then have the unit checked by an expert before using it again.
5. Do not operate the device if the mains cable or the mains plug show signs of damage, if the device has fallen on the floor or has been otherwise damaged. In such cases take the device to a specialist for checking and repair, if necessary.
6. Never remove the mains plug from the socket by pulling on the mains cable, or with wet hands.
7. Ensure that the mains cable does not hang over sharp edges or allow it to become trapped.
8. Keep the appliance away from damp and protect from splashes.
9. Keep the appliance away from hot objects (e.g. hot plates) and open flames.
10. If the supply cord is damaged, it must be replaced by the manufacturer, its service agent or similarly qualified persons in order to avoid a hazard.
11. This appliance is not intended for use by persons (including children) with reduced physical, sensory or mental capabilities, nor lack of experience and knowledge, unless they have been given supervision or instruction concerning use of the appliance by a person responsible for their safety.
12. Children should be supervised to ensure that they do not play with the appliance.
13. The machine should not be operated by means of an external timer-switch or by means of a separate system with remote control.
14. Use the appliance on a flat, dry and heat resistance surface.
15. This appliance is intended to be used in household and similar applications such as staff kitchen areas in shops, offices and other working environments; farm houses; by clients in hotels, motels and other residential type environment; bed and breakfast type environments.
16. Never leave the device in unattended during use.
17. Do not store or operate the appliance in the open air.
18. Keep the appliance in a dry place, inaccessible to children (in this packaging).
19. Never put fingers or any other objects through the grilles (fan guards) when the fan is running.
20. Never operate the product without the grilles (fan guards) in place, as serious personal injury may result.
21. The appliance must be assembled completely before use.
22. Watch out for long hair! It can be caught in the fan owing to the air turbulence.
23. Do not point the air flow to the people for a long time.
24. Ensure that the fan is switched off from the supply mains before removing the guard.

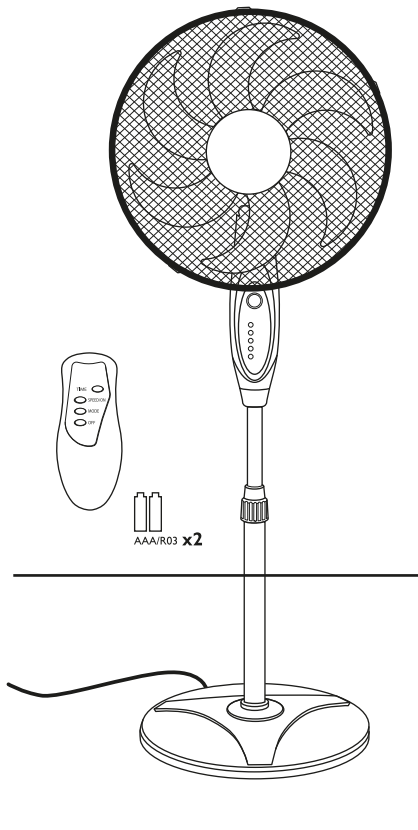

WEEE label signifies the necessity of selective collection of waste electric and electronic equipment. The products thus marked must not be disposed of to the standard waste bins together with other types of waste. Such products may be environmentally harmful and require special forms of processing, recovery, recycling and neutralization. Products designated in this way should be handed over to a used electronic and electrical equipment collection point. They may also be returned to the seller, in case of purchasing a new similar product; in this case, the number of returned products may not exceed the number of purchased new products of the same kind. More information on used electronic and electrical equipment collection points may be obtained from city halls and district offices, as well as from local recycling centers or from the shop where this appliance was bought.



**IMPORTANT:**

The Importer/Supplier bears no responsibility for damages resulting from inappropriate installation, application of inappropriate components, technical modifications and failure to comply with these instructions.

Img.1



**ATTENTION:**

Turn the device off and unplug it before you replace/assemble any parts.

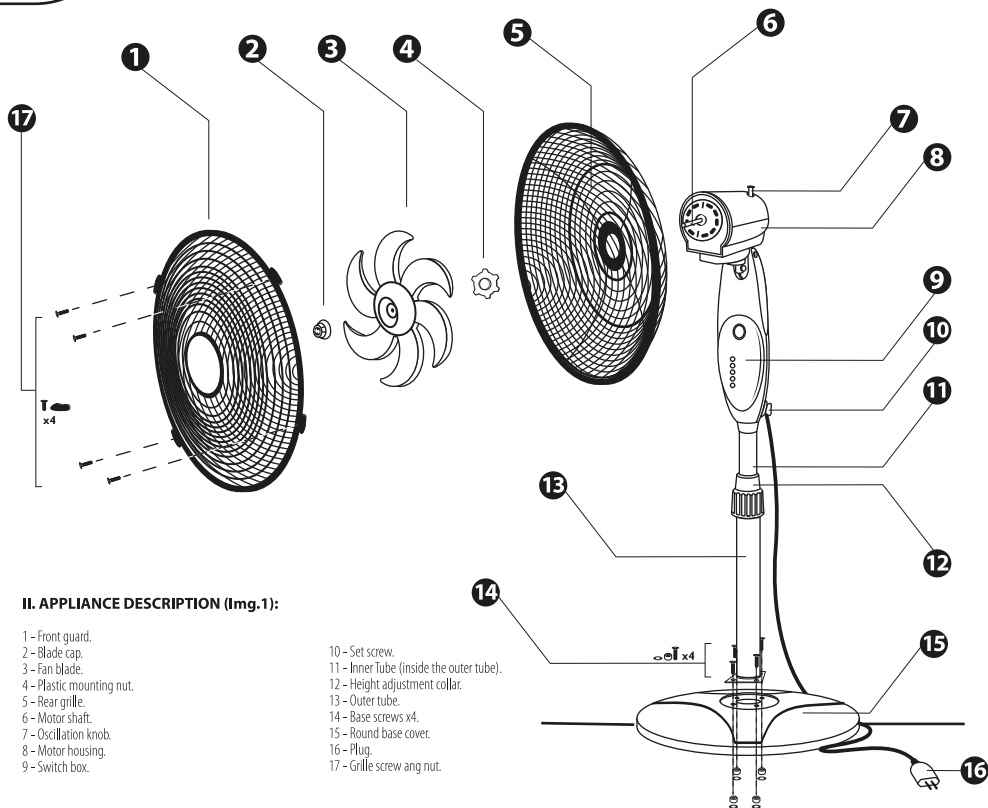

**II. APPLIANCE DESCRIPTION (Img.1):**

- 1 - Front guard.
- 2 - Blade cap.
- 3 - Fan blade.
- 4 - Plastic mounting nut.
- 5 - Rear grille.
- 6 - Motor shaft.
- 7 - Oscillation knob.
- 8 - Motor housing.
- 9 - Switch box.

- 10 - Set screw.
- 11 - Inner Tube (inside the outer tube).
- 12 - Height adjustment collar.
- 13 - Outer tube.
- 14 - Base screws x4.
- 15 - Round base cover.
- 16 - Plug.
- 17 - Grille screw and nut.

Img.2

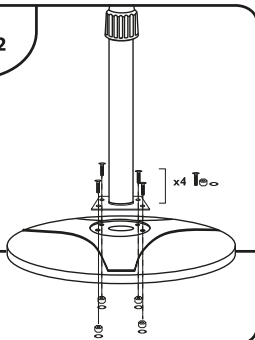

Img.3

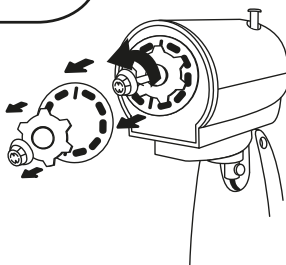

Img.4

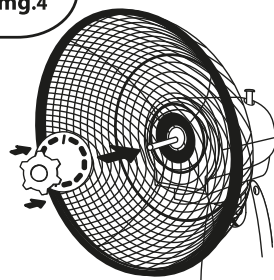

Img.5

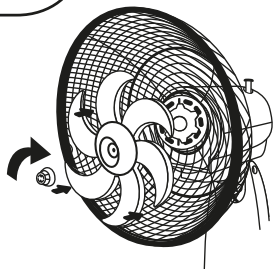

Img.6

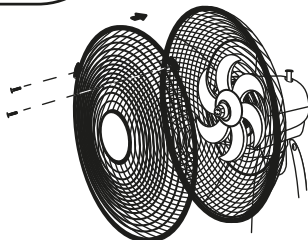

Img.7

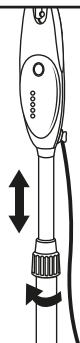

#### IV. HOW TO OPERATE:

1. Make sure you read all safety warnings before first time use.
2. Plug the cord to a power outlet and turn on the power main switch.
3. Use the speed control knob, set the desired speed.
4. The fan can operate at 3 speed settings (low speed-mid speed-high speed-turn off the fan )
5. To turn the fan to swing mode, press the oscillation knob to move it to downward position. Pull knob to up position to stop the swing mode.
6. Timer-Fan's working time can be set between 0.5 hour to 7.5 hour by pressing timer button and choosing the time.
7. Mold:nature mold and sleep mold.
8. Light:push light button can light on the LED.

#### V. CLEANING AND MAINTENANCE:



##### ATTENTION:

Turn the device off and unplug it before cleaning.

9. Keep this unit in cool dry place
10. To keep the fan clean, use a piece soft cloth soaked with soap water off the dust and stains, Wipe dry to keep in a fresh appearance. Must not attempt to use solvents like thinner gasoline, etc.
11. After the fan is cleaned then pack it into a vinyl bag and store it in a dry place.

#### VI. TECHNICAL PARAMETERS:

Input rated voltage: 220-240V~

Frequency: 50Hz

Power: max 75W

II class protection - a product in which protection against electric shock is provided not only through basic insulation, but also double or reinforced insulation. Product meets the requirements of EU directives.

Img. 8

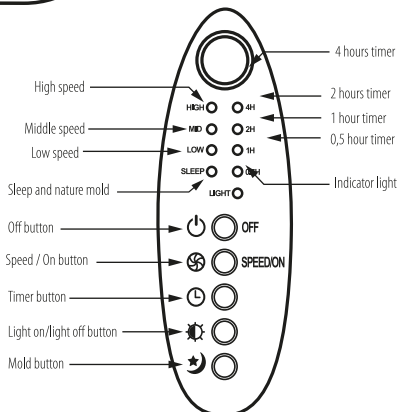

Img.9

